

# EVACLITE

Dynamic & Adaptive, Emergency  
Exit Signage

“Only 38% of people notice  
standard static escape route  
signs and use them to find their  
way out.”



## Product Data Sheet ATHENA

Apr 2026



standard ISO7010



standard no entry



US exit

## 1.0 OVERVIEW

### Athena

Athena is a surface mounted, LED matrix based, maintained or non-maintained, self-test dynamic exit sign.

The nature of the display enables it to display the conventional 'running man' legend but also allows the user to choose from 15 pre-programmed alternatives and static or dynamic movement providing additional safety and control (see below).

It is compatible with any fire panel and connects to the fire loop via a suitable input/output device or relay.

The sign's behaviour in an emergency is defined by the fire strategy and dictated by cause-and-effect programming of the panel.

The screen icons/legend and the sign's state and behaviour may be set to suit at installation via switches located within the unit.

It is ideal for wall installation due to its back box design and can be quickly installed and connected.



### Dynamics

In an emergency, most people fail to see conventional, static emergency exit signage.

Stress grows, decision-making slows and risk increases. Furthermore, even if the signs are seen, and followed, they cannot adapt to the surroundings and could direct you towards an unsafe exit route.

Evaclite has developed a range of dynamic and adaptive emergency exit signage.

Our leading technology helps keep people safe because it:

- Is quicker to see and easier to understand.
- Reduces decision-making time.
- Adds an additional level of control.
- Reduces congestion at exits.
- Helps ensure a more efficient evacuation.

It plays a critical role in ensuring that everyone leaves calmly and safely, via their nearest, safest exit every time.



### Athena legend options

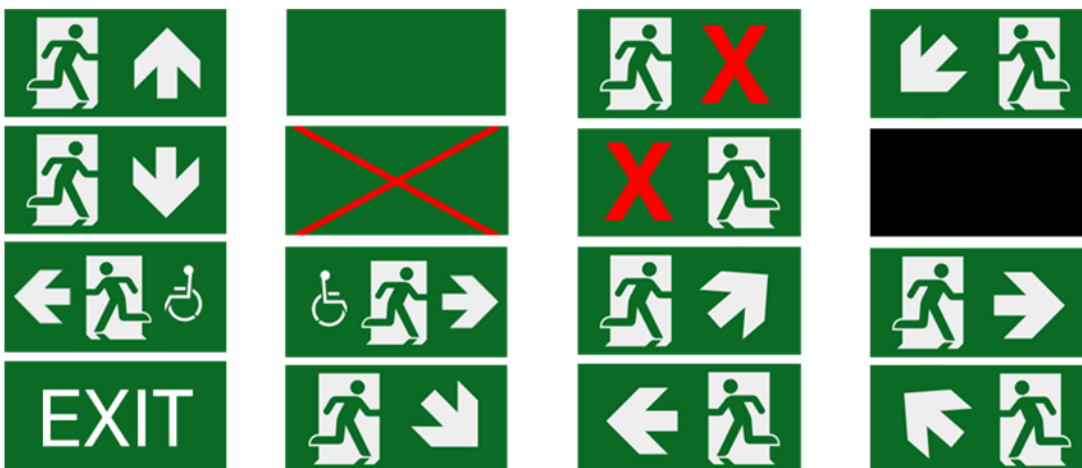

These are for illustrative purposes only and are not representative of the actual unit.

## Viewing distance

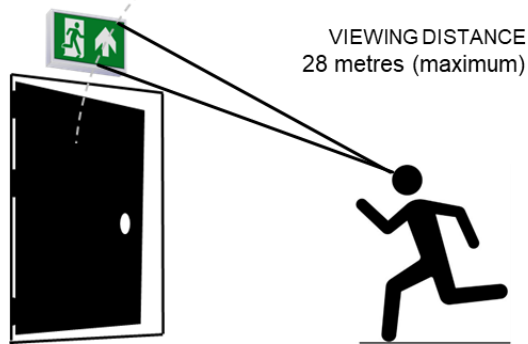

## Dimensions

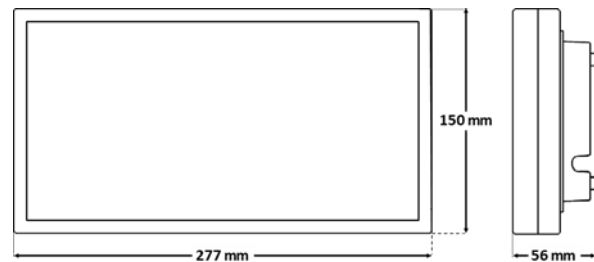

## Features

- Fully dynamic, maintained, non-maintained and addressable, emergency exit sign with x16 pre-programmed legends, three possible states (alternate legends) and two behaviours (static or dynamic).
- Self-test as standard.
- 2-channel, 6-volt (maximum) connectivity.
- Self-contained with 2x 6.4V, 1200mAh, LiFeO4 battery pack for 3-hour operation.
- LED life circa 36k hours
- Suitable for wall installation and internal use (IP20).

## Construction & function

- Body – ABS & PC (plastic) RAL9010 (white).
- Legend panel – LED matrix display capable of displaying green or red illumination.
- Weight – 0.84kg.
- Maintained State: 12W (max).
- Dynamic State: 12W (max).
- Mains voltage: 230-240VAC, 50/60Hz.
- Triggering voltage: 6VDC (max).

See 2.0 Technical section for additional detail.

## Options

- Alternate legends (for quantity).
- Central battery version.
- DALI – available mid-2026.
- Black finish (for quantity).
- Alternative mounting bracketry (for quantity).

## Compliance

- Produced in accordance with EN60598.1, EN60598.2.22, EN 55015, EN 61547, EN 61000.3.2 and EN 61000.3.3, with ISO7010 style legend.

## 2.0 TECHNICAL

### Installation

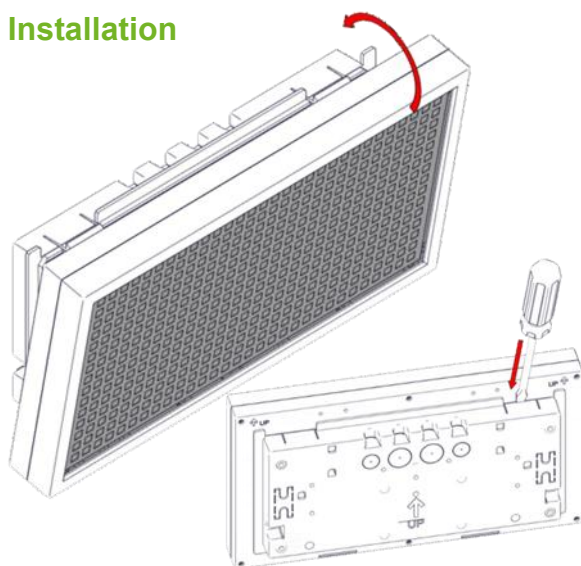

### Self-test

| GREEN (charge) | RED (fault) | Description   |
|----------------|-------------|---|
| ●              | ○           | Normal  |
| ●              | ○           | Charging (autonomy test not possible while charging)            |
| ○              | ○           | Mains off (battery not connected or charger fault)              |
| ●              | ○           | Autonomy Test (Duration: 1h, 3h, 8h)                            |
| ∅              | ●           | Battery Fault   |
| ●              | ○           | Operational Test (Duration: 3s)                                 |
| ∅              | ●           | Light Source Fault  |
| ∅              | ●           | Battery Fault & Light Source Fault                              |
| <b>Note:</b>   |             | ● Permanently ON ● Fast Blink ● Slow Blink ○ Off ∅ Non relevant |

## Installation contd.

Athena may be fitted to solid or plasterboard walls. (See Product Instructions.)

The unit is retained by six screw fittings thus:

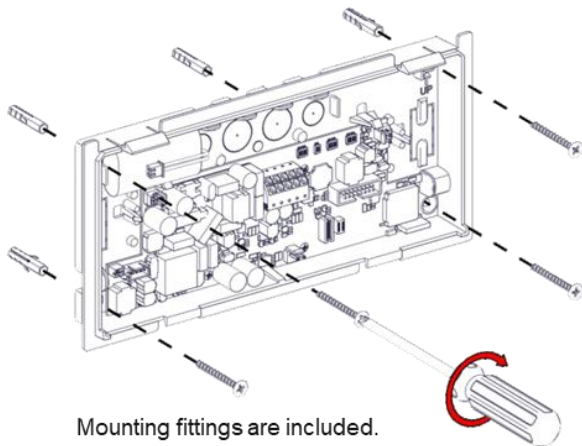

Mounting fittings are included.

## Power connection

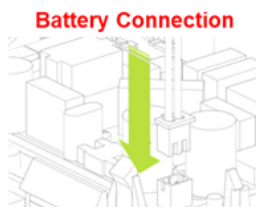
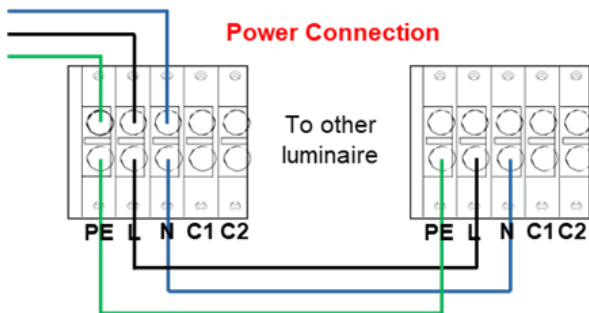

## Setting the legend(s)

Please set DS1 to DS4 in accordance with the black and white panel below to trigger legend shown. DS1 = normal conditions, DS2 = alarm conditions, DS4 = static/moving icon mode.

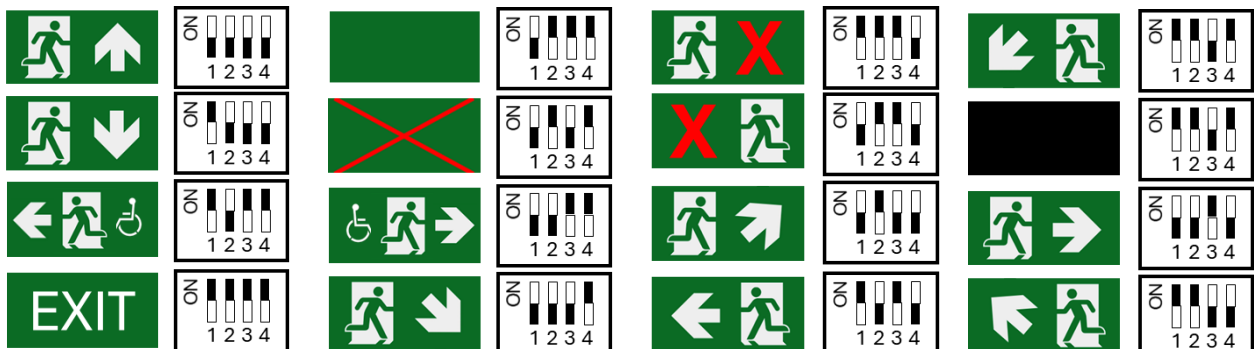

## Fire alarm connectivity

Athena can connect to any control panel that can send an alarm signal.

Once triggered, the legends change in accordance with the user's requirements.

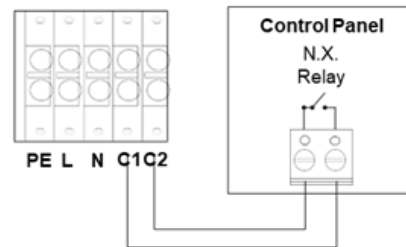

Connect the panel's cables to the appropriate connectors on the terminal block:

It is recommended to connect the power supply cable to the panel (CN6) last.

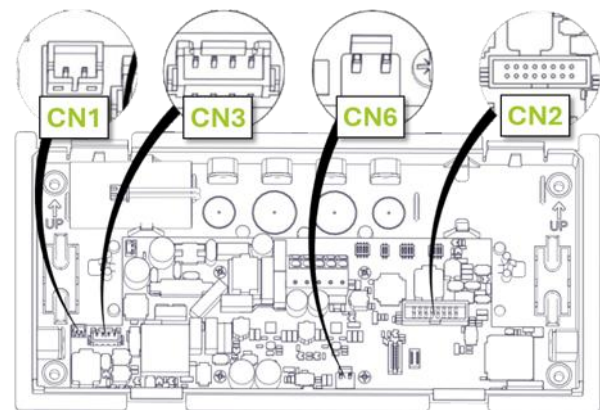

- CN1 operates the optional downlight located at the underside of the sign.
- CN2 enables connection to the panel.
- CN3 indication LEDs and the test button.
- CN6 supplies power to the panel.

## Operation – normal state

Primary legend is on (typically the running man).

In this situation, the signage looks like a typical, maintained (or unmaintained), ISO7010 style, emergency exit signage.

The charge indicator LED on the underside indicates the unit's status.

## Operation – emergency state

The sign's behaviour is dictated by the panel and in accordance with the building's fire strategy.

Typically, when the alarm sounds, the secondary legend shows. If an area or route becomes compromised, then signage in that area, and only in that area, typically turns to a red cross.

If a red cross is activated, a sign showing a green arrow must be visible.

## Control gear & technical information

| Item  | Specification – Athena   |
|---|--|
| Ingress protection rating                     | IP20   |
| Operation voltage                             | 220-240 VAC / 50-60Hz  |
| Current                                       | 60mA   |
| Power consumption (max)                       | 12W / 12.5Va   |
| U-Out   | 6V   |
| P rated                                       | 18W  |
| I rated                                       | 300mA  |
| Circuit voltage (max)                         | 6V   |
| Wire cross section                            | 0.8 – 2.5mm <sup>2</sup>   |
| Power factor (min)                            | 0.96   |
| Insulation between supply & control terminals | Basic  |
| Insulation between supply & battery circuit   | Basic  |
| Battery (LiFePO <sub>4</sub> )                | 2 x 6.4V / 1200mAh   |
| Battery protection                            | Deep discharge & overcharge protection<br>The control gear will recharge the battery normally after the test of 22.3 |
| Discharge voltage (min/max)                   | 5.4V – 7.1V  |
| Discharge current (min/max)                   | 550 – 710mA  |
| Charge current (min/max)                      | 100 – 200mA  |
| Trickle charge voltage/current                | 7.1V – 0mA   |
| Charger voltage (max)                         | 7.5V   |
| Indications/controls                          | LED Fault, LED Charge / Test Button  |
| Charge time                                   | 23 hours   |
| Duration (min)                                | 3 hours  |
| Operational temperature range                 | 4 – 40°C   |
| Control gear maximum temperature: tc          | 62° Cat Q3   |
| Relative humidity                             | Up to 95%  |
| Construction material                         | ABS/PC, PC   |
| Dimensions (external – L x W x H)             | 227 x 150 x 56mm   |
| Weight  | 840g   |
| Warranty period                               | 5 years  |
| Control gear with automatic test function     | <b>EL-T</b>  |
| Voltage range                                 | 2.6V - 2.7V  |
| Nominal power (3h)                            | 0.8W   |
| Connections                                   | Cable  |
| Temperature (tc)                              | 43°C max. across the board   |
| Produced in accordance with                   | EN 60598-1, EN 60598-2-22, EN 55015, EN 61547, EN 61000-3-2, EN 61000-3-3  |

### 3.0 ORDERING INFORMATION - Athena

| Description                  | Part No               | Front   | Reverse   | Description                       | Part No                  | Front   | Reverse   |
|------------------------------|-----------------------|---|---|-----------------------------------|--------------------------|---|---|
| Single-sided, matrix display | ATH/DN1001/S/28/A*-W_ |  |  | Single-sided, matrix display, CBS | ATH/DN1001/S/28/A*-W_CBS |  |  |

1. Above part numbers cover self-test.
2. CBS = central battery system or uninterruptable supply.

#### Address

- Evaclite Ltd  
Thorncroft Manor  
Thorncroft Drive  
Leatherhead  
Surrey  
KT22 8JB  
[Google maps](#)

#### Contact & links

- 01633 404999
- [info@evaclite.com](mailto:info@evaclite.com)
- <https://evaclite.com/>
- [Products](#)
- [Technical information](#)

Evaclite Ltd reserves the right to change any specification, function, or appearance without notice.